



A Division of The Legacy Companies

MODEL UC-20

UNDERCOUNTER DISHWASHER

FEATURES:

- The Largest Door Opening in the industry at 18-5/16"
- 18 gauge Stainless Steel tank construction
- Up to 45 Racks per Hour
- All stainless steel, interchangeable Upper and Lower wash and rinse arms – easily removable for easy cleaning
- Built-in 6.6 kW booster
- Water consumption as low as 0.6 gallons per rack
- Quiet (low dB) Wash and Rinse
- 1.2 kW wash tank heater
- Built-in Detergent and Rinse Aid dispensers with hook-up provided
- Pump Drain provides versatility for installation locations
- Fully insulated wash compartment provides superior energy savings through consistent heating
- Cool-to-the-touch exterior
- Door Safety Switch
- Automatic tank fill with liquid level safety switch
- Stainless steel filters to protect Wash Pump
- Seven independent cycles: economy, economy plus, glassware, flatware, dishware, pot & pan, and programmable
- Intuitive Digital Display with cycle indicator light provides simplified Operational Instructions and allows for long range visibility
- Power Saving mode automatically regulates and reduces energy consumption if unit is left unattended for over 30 minutes.



OPTIONAL EQUIPMENT:

- Final rinse pump
- Modification Kit for 18 x 26 pans
- Locking Latch for Shipboard Use
- Flanged feet for Shipboard Use



A Division of The Legacy Companies

MODEL UC-20

UNDERCOUNTER DISHWASHER

DIMENSIONS

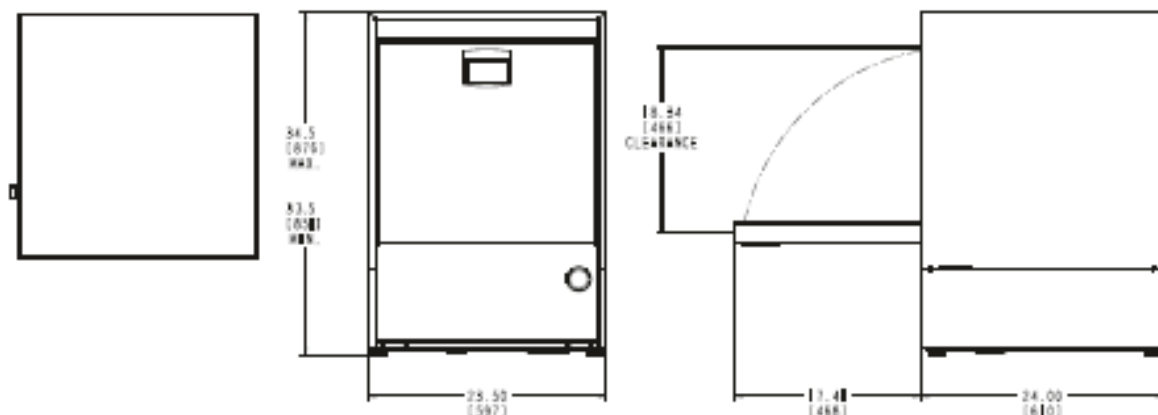

SPECIFICATIONS	
RACK SIZES	
DISH RACK	20" x 20"
FLAT RACK	20" x 20"
MOTOR	
HORSEPOWER	0.94
APPROX. SHIPPING INFO	
DIMENSIONS	30" x 30" x 42"
WEIGHT	140 lbs
ELECTRIC	
Voltage/Hertz/Phase	220-240/50-60/1
Total Amps	32.0 – 35.0
Voltage/Hertz/Phase	208-240/50-60/3
Total Amps	20.0 – 21.5
Voltage/Hertz/Phase	380-415/50-60/3
Total Amps	12.0

*Other voltages available – contact factory

All specifications are subject to change
All specifications are dependent on water pressure and temperature

MODEL UC20	USA	METRIC
WATER CONSUMPTION		
PER RACK	0.6 – 0.8 (gal)	2.2 – 3.0 (l)
OPERATING CYCLE		
WASH TIME (sec)	35 - 180	35 - 180
RINSE TIME (sec)	12 – 20	12 – 20
DWELL TIME (sec)	5 – 10	5 – 10
TOTAL CYCLE (sec)	52 – 203	52 – 203
OPERATING CAPACITY		
RACKS PER HOUR	45 - 20	45 - 20
WASH TANK CAPACITY	1.8 (gal)	6.8 (l)
CYCLE TEMPERATURES		
WASH	150°F - 160°F	66°C - 71°C
RINSE	180°F - 195°F	82°C - 91°C
WATER REQUIREMENTS		
INLET TEMPERATURE	140°F	60°C
FLOW PRESSURE	20-25 psi	1.4 – 1.7 kg/cm ²
WATER INLET CONNECTION	3/4" npt	3/4" npt
DRAIN CONNECTION	3/4" I.D.	3/4" I.D.

eurodib

F92EKDPS DISHWASHER



LAMBER dishwashers are **less expensive at purchase and less expensive to use**



WARRANTY
1 year
parts & labor



Features and Benefits

- Stainless steel construction** AISI 304 18/10: 208 – 240 volts, single phase.
- Double skin with acoustic & thermal insulation** Less water consumption and energy efficient.
- Wash tank slanted with rounded edges** Seamless interior prevents leakage.
- Rotating stainless steel upper & lower wash rinse arms** Longer lasting and easier to clean.
- Digital read out** For easy read, with 2, 3, 4 and 15 minute cycle.
- Automatic loading tank** Tank fills up as soon as the machine is turned on.
- Integral tank filter kit** Prevents food particles getting into the machine.
- Rinse aid dispenser and detergent pump** Dispenses detergent and rinse aid efficiently.
- Door opening safety device** Machine shuts off automatically.
- Thermo control** Guarantees selected temperature for every rinse cycle and when machine is not in use. **Security thermostat** Automatic booster shut off.
- Extractable control panel** For easy maintenance.
- Soft Start** Prevents over pressure water spillage and easy on glassware and china.
- Undercounter dishwasher** F92EKDPS – (Soft Start) with booster, rinse, drain & soap pumps.
- Included accessories** (2) baskets, (1) general basket, (2) cutlery containers.

eurodib

Please consult our web site www.eurodib.com for additional information on other product lines.
 US 158 Lawrence Paquette, Champlain, NY 12919 | CAN 120 rue de la Barre, Boucherville, Qc J4B 2X7
 Tel.: 1 888 966 6886 | Fax: 1 877 966 6867 | www.eurodib.com



SIZE:
23 5/8" W x 25 1/2" D x 32 1/4" H
 Cycle period: 2-3-4 minutes
 Capacity per hour:
 Baskets/H: 30/20/15
 Dishes/H: 540/360/270
 Dishes per basket 12-18

Accessories:
2 baskets for dishes;
1 generic basket;
2 cutlery containers;

OPTIONS
-Tank drain unit with filter,
-Stainless steel base H17,72 inch

F92EKDPS

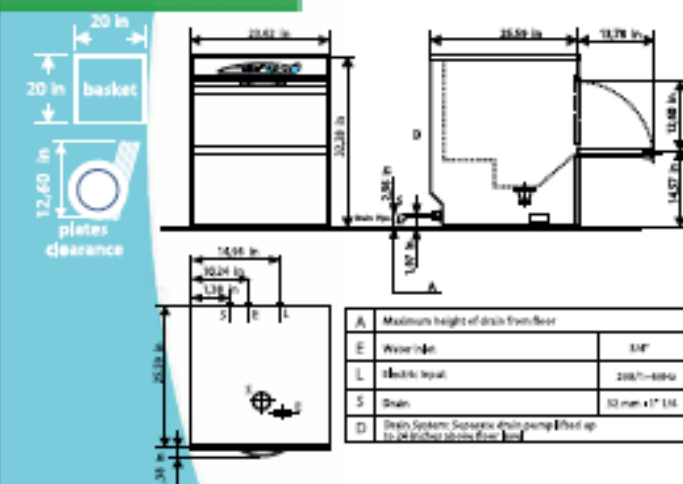

lamber

- Undercounter dishwasher;
- Stainless steel construction 18/10 AISI304;
- Wash cycle time: 2-3-4 minutes;
- Endless cycle: max 15 minutes;
- Soft touch electronic control panel;
- Temperature's electronic display;
- Double skin with thermic and acoustic insulation;
- Cycle start with soft-start system;
- Stainless steel lower and upper rotating wash arms;
- Stainless steel lower and upper rotating rinse arms;
- Self-washing slanted tank with rounded edges;
- Integral tank filters;
- Pressed self-cleaning door;
- Extractable control panel for an easy maintenance;
- Rinse aid dispenser;
- Detergent pump;
- Automatic tank loading;
- Door opening safety device;
- Thermocontrol: device which guarantees the selected temperature for every rinsing cycle even in case of non stop work;
- Security thermostat;
- Certifications: UL, UL Sanitation;



Specifications	F92EKDPS	
VOLTAGE	208 V1ph 60Hz	V
WASHING PUMP	650	W
WASH TANK ELEMENTS	2000	W
RINSE TANK ELEMENTS	6000	W
TOTAL RATING	6650	W
MAX CURRENT INTENSITY	34	A
PLATES CLEARANCE	12,60	inch
WORK HEIGHT	14,57	inch
TANK CAPACITY	4,8	Gal
BOILER CAPACITY	1,6	Gal
PUMP DELIVERY	69	Gal/min
WATER CONNECTION	131	"F
WATER CONSUMPTION PER CYCLE	2,40	LT.
WATER CONSUMPTION PER HOUR	52	LT.
WATER PRESSURE	20 ± 5	psi
WATER HARDNESS	5 ÷ 10	TH("F)
RINSING WATER TEMPERATURE	179 ÷ 194	"F
WATER INLET	3/4"	inch
WATER OUTLET	1" 1/4 (3/4" BOPS)	inch
NET WEIGHT	152	Lbs
GROSS WEIGHT	165	Lbs
PACKING SIZE	34,80H x 28,17D x 44,09H	inch
NOISE LEVEL	<60	dB(A)

The manufacturer reserves the right to make modifications of materials and sizes without warning.

lamber

Z.I. Via Italia, 6 - 26855 Ledveglio (L.O) Italy
 Tel. (0371) 753202 - 754248-9 Fax (0371) 752928
www.lamber.com - e-mail: info@lamber.it

COMPANY
WITH QUALITY SYSTEM
CERTIFIED BY DNV
ISO 9001/14001



lamber

•Undercounter dishwasher;

- Stainless steel construction 18/10 AISI 304;
- Wash cycle time: 2 minutes;
- Wash and rinse temperature thermometers;
- Stainless steel lower and upper rotating wash arms;
- Stainless steel lower rotating rinsing and upper fixed;
- Extractable control panel for an easy maintenance;
- Rinse aid dispenser;
- Detergent pump;
- Automatic tank loading;
- Door opening safety device;
- Thermocontrol: device which guarantees the selected temperature for every rinsing cycle even in case of non-stop work;
- Security thermostat;

•Certifications: UL, UL Sanitation;



SIZE:
23,75 x 25,00 x H32,28 inch

Cycle period: 2 minutes

Capacity per hour:
Baskets/H 30

DSP4

Accessories:

- 1 basket for dishes;
- 1 generic basket;
- 1 cutlery container;

OPTIONS:

- Stainless steel base H17,72 inch,

Specifications	DSP4	
VOLTAGE	208 V1ph 60Hz	V
WASHING PUMP	650	W
WASH TANK ELEMENTS	2000	W
RINSE TANK ELEMENTS	3000	W
TOTAL RATING	3650	W
MAX CURRENT INTENSITY	20	A
PLATES CLEARANCE	11,81	inch
WORK HEIGHT	12,40	inch
TANK CAPACITY	15	Lt.
BOILER CAPACITY	3	Lt.
PUMP DELIVERY	260	Lt./min
WATER CONNECTION	131	°F
WATER CONSUMPTION PER CYCLE	2,4	Lt.
WATER CONSUMPTION PER HOUR	72	Lt.
WATER PRESSURE	20±5	psi
WATER HARDNESS	5 + 10	TH(°F)
RINSING WATER TEMPERATURE	179 + 194	°F
WATER INLET	3/4"	°G
WATER OUTLET	1 1/4"	°G
NET WEIGHT	43	Kg
GROSS WEIGHT	48	Kg
PACKING SIZE	/24,80xL28,37xH44,09	inch
NOISE LEVEL	<70	dB(A)

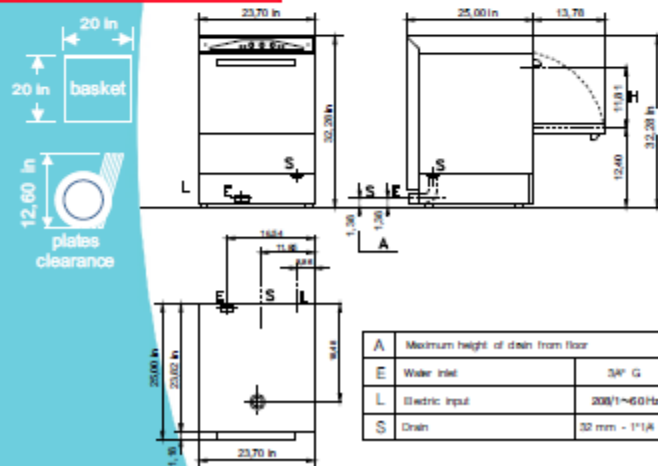

The manufacturer reserves the right to make modifications of materials and models without notice.

lamber

Z.I. Via Italia, 6 - 26855 Lodivechio (LO) Italy
Tel. (0371) 753202 - 754248-9 Fax (0371) 752928
www.lamber.com - e-mail: info@lamber.it

COMPANY
WITH QUALITY SYSTEM
CERTIFIED BY DNV
= ISO 9001/2000 =